

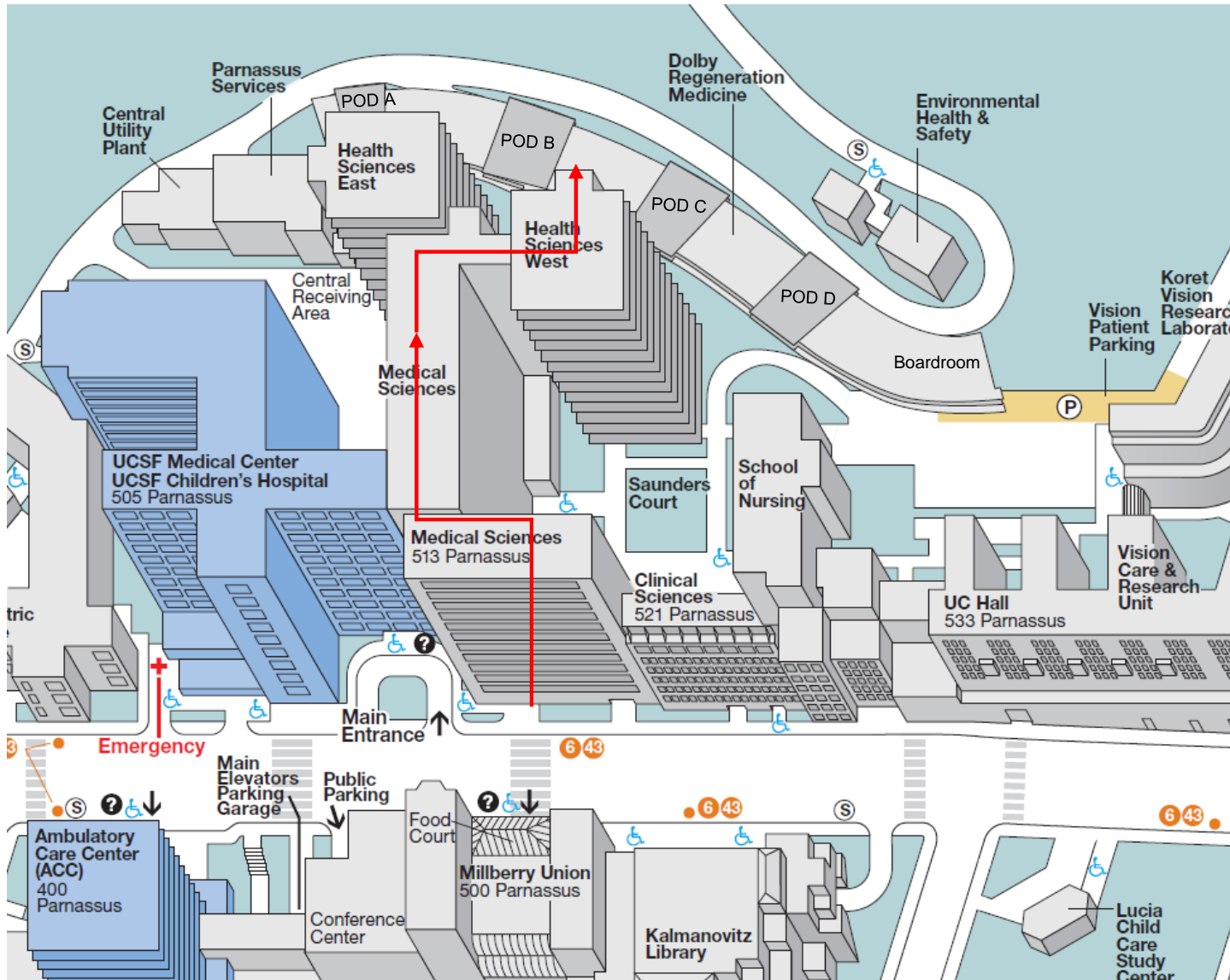

Directions to the Boardroom located in the Eli and Edythe Broad Center of Regeneration Medicine and Stem Cell Research Headquartered in the Ray and Dagmar Dolby Regeneration Medicine Building (RMB)



- Use the Medical Sciences Bldg., Entrance at 513 Parnassus
- Take the left-side bank of elevators to the 9th Floor
- Exit the elevators and take a left down the long hallway toward a set of cream double-doors.
- Turn right and pass two doors on your left before you come to a set of blue double doors.
- Through those blue double doors you will encounter a set of glass double doors.
- Walk through the glass doors and down the bridge to the security desk for check in.
- If you visiting a specific POD, please ask security and they will direct you to the right entrance and path.
- For the Boardroom, make a right and walk the ramp alongside the building to the last set of stairs. The boardroom entrance is located at the top.

Please note this is a secure building and ALL visitors must check in with the security desk at the end of the bridge to the left. Anyone with a UCSF ID just needs to show their badge to security to gain access.



Directions to the Eli and Edythe Broad Center of Regeneration Medicine and Stem Cell Research

Headquartered in the Ray and Dagmar Dolby Regeneration Medicine Building

Directions to Brack Lab in the Regeneration Medicine Building

- Use 513 Parnassus Bldg, Entrance (Medical Sciences)
- Take the left-side bank of elevators to the 9th Floor
- Exit the elevators and take a left down the long hallway toward a set of cream double-doors.
- Turn right and pass two doors on your left before you come to a set of blue double doors.
- Through those blue double doors you will encounter a set of glass double doors.
- Walk through the double doors and down the bridge to the security desk for check in.

Please note this is a secure building and ALL visitors must check in with the security desk at the end of the bridge to the left. Anyone with a UCSF ID just needs to show their badge to security to gain access.



- Use 513 Parnassus Bldg, Entrance (Medical Sciences)

- Take the left-side bank of elevators to the 9th Floor
- Exit the elevators and take a left down the long hallway toward a set of cream double-doors.
- Turn right and pass two doors on your left before you come to a set of blue double doors.
- Through those blue double doors you will encounter a set of glass double doors.
- Walk through the double doors and down the bridge to the security desk for check in.

Please note this is a secure building and ALL visitors must check in with the security desk at the end of the bridge to the left. Anyone with a UCSF ID just needs to show their badge to security to gain access.



Directions to the Eli and Edythe Broad Center of Regeneration Medicine and Stem Cell Research

Headquartered in the Ray and Dagmar Dolby Regeneration Medicine Building (RMB)

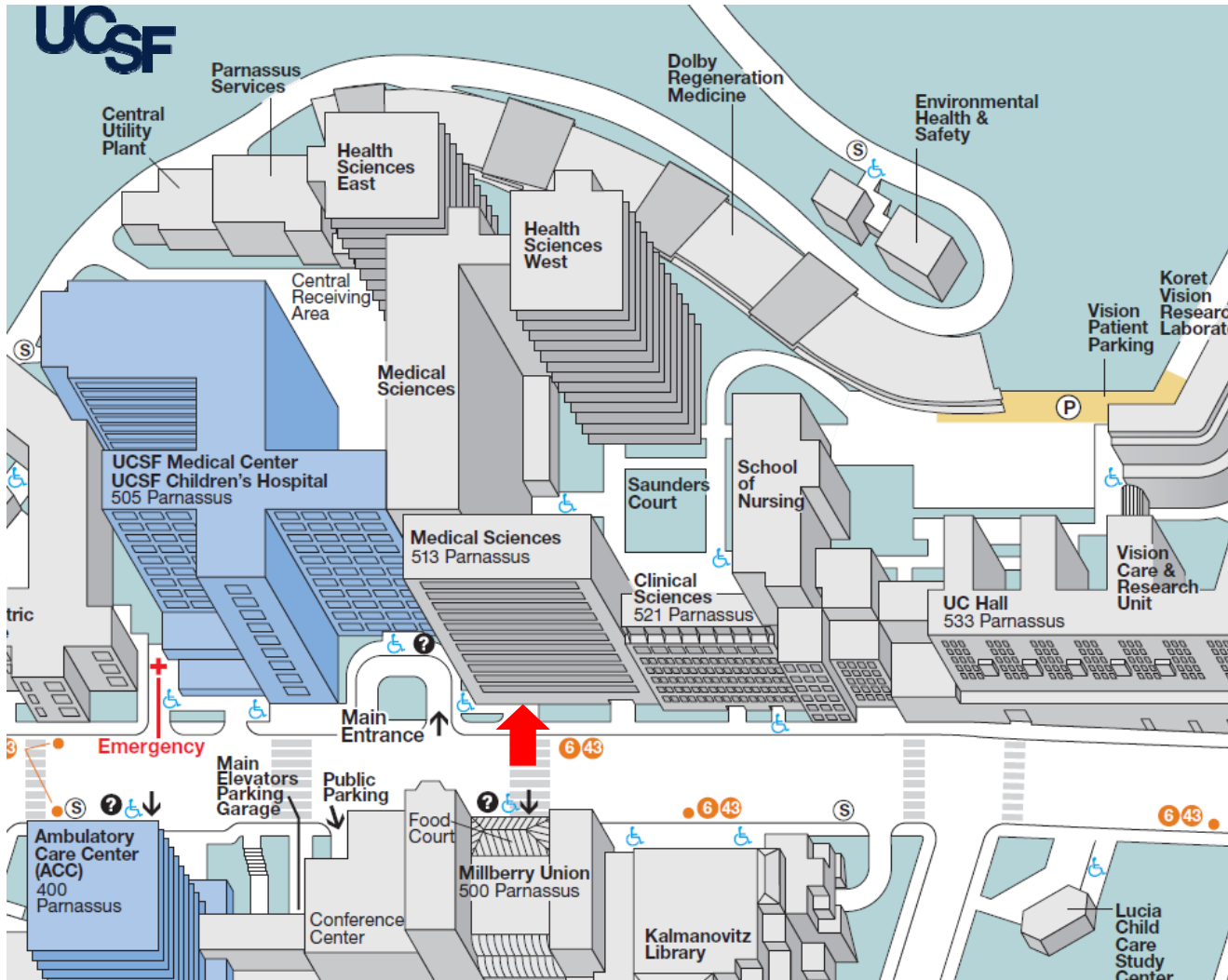

- Use 513 Parnassus Bldg., Entrance (Medical Sciences)
- Take the left-side bank of elevators to the 9th Floor
- Exit the elevators and take a left down the long hallway toward a set of cream double-doors.
- Turn right and pass two doors on your left before you come to a set of blue double doors.
- Through those blue double doors you will encounter a set of glass double doors.
- Walk through the glass doors and down the bridge to the security desk for check in.
- After check in, make a right and walk the ramp to the last set of stairs. You'll reach the boardroom once at the top.

Please note this is a secure building and ALL visitors must check in with the security desk at the end of the bridge to the left. Anyone with a UCSF ID just needs to show their badge to security to gain access.